

Rubio® MONOCOAT
— MAINTENANCE —



Oil Plus 2C

EN

CLEANING

Your interior wood is used daily, meaning it has to endure a lot. Thanks to our Rubio Monocoat products, your wood is given an optimal and long-term protection. In this maintenance brochure we show you how to clean, maintain and refresh your oiled wood surfaces.

All Natural Wood Cleaner is a safe, durable and user-friendly cleaner for all wooden surfaces. Thanks to the microbiological characteristics and the active microorganisms, the product is self-cleaning and has a long-term after-effect. This guarantees less new soiling, which is also easier to remove during the next cleaning.



ALL NATURAL WOOD CLEANER

Microbiological cleaner for cleaning wooden floors

This product needs to be diluted with water and is suitable for cleaning floors and large surfaces.

INSTRUCTIONS:

01. Vacuum the surface. Remove dust, sand, stones, ... **02.** Pour 10 ml (5 pumps) of All Natural Wood Cleaner into a 5-8 L bucket with lukewarm water (max. 40°C). **03.** Clean the surface with a mop or cloth. *Caution:* do not leave water on the surface, it is sufficient to simply clean damp. **04.** Allow to dry. Do not walk on the floor until it is completely dry. Rinsing with clean water is not necessary.



ALL NATURAL WOOD CLEANER SPRAY

Ready-to-use spray version of All Natural Wood Cleaner

This product is suited for smaller surfaces such as furniture, tables, worktops and local spots.

INSTRUCTIONS:

01. Make the surface dust-free. **02.** Spray All Natural Wood Cleaner Spray onto the surface. **03.** Rub dry with a mop or Microfibre Cloth. **04.** Allow to dry. Rinsing with clean water is not necessary.

ALL NATURAL WOOD CLEANER APPLICATION

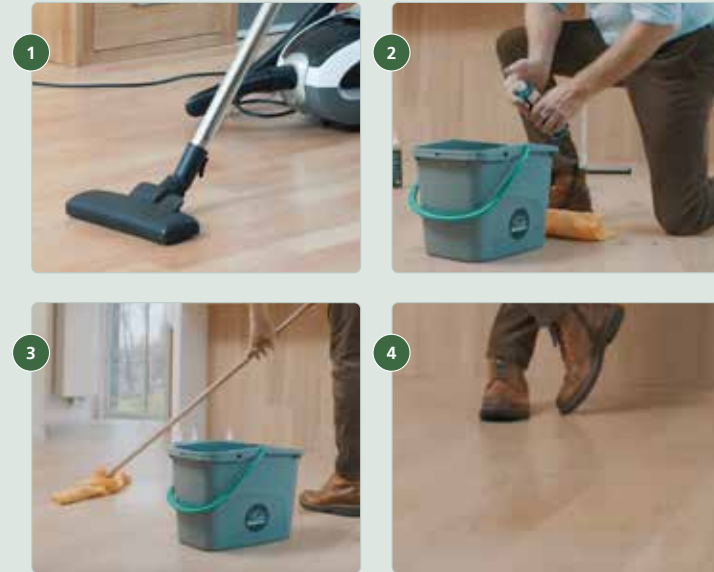

SCAN TO WATCH A HOW TO VIDEO



ALL NATURAL WOOD CLEANER SPRAY APPLICATION



SCAN TO WATCH A HOW TO VIDEO



CLEANING



UNIVERSAL SOAP

Soap for regularly cleaning all interior oiled wooden surfaces

Universal Soap is the ideal product for cleaning all oiled surfaces. The product ensures that your surface remains in top condition and that all dirt and grease are thoroughly removed. In addition, the wood retains its matt, natural look. Universal Soap is also very concentrated and hence extremely low in consumption.

INSTRUCTIONS:

01. Vacuum the surface. Remove dust, sand, stones, ... **02.** Pour a maximum of 50 to 100 ml of Universal Soap in a bucket with 10 litres of water. **03.** Clean the surface with a mop or Microfibre Pad. **04.** Rinse with clean water. Careful: do not leave water on the surface, it is sufficient to clean damp. **05.** Allow to dry for ± 15 minutes. Do not walk on the floor until it is completely dry.



SURFACE CARE

Ready-to-use spray version of Universal Soap

Surface Care is the handy, ready-to-use version of Universal Soap. The environmentally friendly soap is well suited for fast cleaning of small floor surfaces and local spots on wooden floors, coffee tables, counter tops, ...

INSTRUCTIONS:

01. Vacuum the surface. Remove dust, sand, stones, ... **02.** Spray Surface Care onto the surface. **03.** Clean the surface with a Microfibre Cloth. **04.** Allow to dry (± 15 min). Do not use the surface until it is completely dry.



- We recommend cleaning with Universal Soap or Surface Care no more than once a week. When cleaning too often or with too high a dosage of Universal Soap or Surface Care, a light layer can be left on the surface that will trap dust and dirt.
- Do not leave water on the surface, it is sufficient to clean damp. Do not walk on the floor until it is completely dry.
- The best working method is with two buckets: one with the soap mixture and one with clean water to rinse the dirt out of the mop.

How do I clean my wooden surface for the first time after applying the oil?



May be done after a drying time of **48 hours**



May be done **5 days** after application

How do I continue to keep my wooden surface clean?



May be done **frequently**

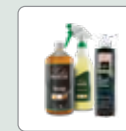

Max. once a week

UNIVERSAL SOAP APPLICATION



SURFACE CARE APPLICATION



REMOVING STAINS

Although many stains can be removed with our cleaning products, we also developed a number of specific stain removers. Stubborn lime stains can be handled effectively with Limespot Remover, grease stains with Grease Remover and black/tannin stains with Tannin Remover. If the stain has penetrated the wood too deeply, the spot can be sanded and re-oiled.



GREASE REMOVER

Ready-to-use spray for removing grease stains

Grease stains, e.g. oil (olive, frying oil, crisps, etc.) • Heel marks • Floor polish



LIMESPOT REMOVER

Ready-to-use spray for removing lime water stains

Lime stains and other alkaline stains, e.g. fertilizers, radiator water • White rings • Wine stains



TANNIN REMOVER

Ready-to-use spray for removing black/tannin stains

Black/tannin stains, e.g. urine, rust stains, rings/stains from cans, flower pots • After water damage on parquet • In case of efflorescence on exterior wood (on the bottom of gates, doors, on walls)

INSTRUCTIONS:

01. Spray the product onto the stain. **02.** Let absorb for 2 to 3 minutes. **03.** Dab dry with a cloth or a paper towel (do not wipe!). **04.** To remove stubborn stains, it is recommended to repeat the process until the desired result is achieved. **05.** Clean the whole surface thoroughly after. Use a damp cloth for this or clean with Surface Care or All Natural Wood Cleaner (Spray).



- First try to remove the stain using Universal Soap, Surface Care or All Natural Wood Cleaner (Spray). If the stain is not removed, then use one of the removers. Use them in this order: A. Limespot Remover B. Grease Remover C. Tannin Remover. We recommend this method only in cases where the cause of the stain is unknown. If you know the type of stain you're dealing with, immediately use the correct remover.
- After a treatment with Limespot Remover, Grease Remover or Tannin Remover, you may need to apply some oil in the original colour on the spot.
- If the surface becomes too stain-sensitive, maintain with Oil Plus 2C (in the original colour applied) to repair both colour and protection. More info about this on the next pages.

CLEAN THE SURFACE

with **Universal Soap, Surface Care** or **All Natural Wood Cleaner (Spray)**.



If the stains have not disappeared, proceed to step two.

REMOVE THE STAINS

Remove the lime water stains / grease stains / tannin stains **with the specific stain remover.**



If the stains have not disappeared, repeat the process. If the stains are still there, proceed to step three.

RE-SAND THE SURFACE & OIL LOCALLY WITH OIL PLUS 2C if necessary.

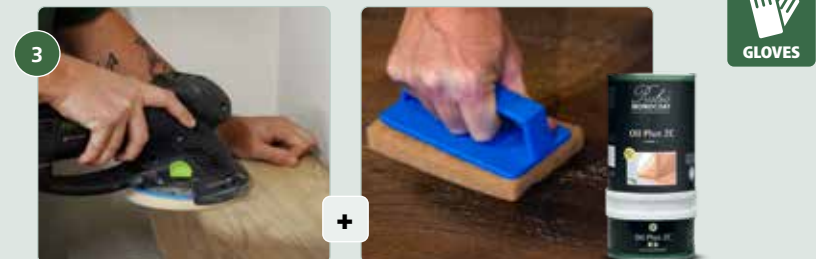

REFRESH



REFRESH ECO

Ready-to-use spray for refreshing furniture that looks dry and worn out

Refresh Eco is a ready-to-use sprayable product that refreshes and restores all wooden tables, worktops and furniture that have been treated with oil.

Depending on wear and tear, Refresh Eco can be applied several times a year at certain areas.

INSTRUCTIONS:

- 01.** Clean the surface to be treated with Universal Soap, Surface Care or All Natural Wood Cleaner (Spray). Allow to dry.
- 02.** Spray a small amount of Refresh Eco onto the surface to be treated.
- 03.** Spread the product in the direction of the wood fibres using the Microfibre Pad or a microfibre cloth.
- 04.** Allow the surface to dry for at least 1 hour before use.



→ Refresh Eco is not pigmented. To restore the colour, use Oil Plus 2C or Universal Maintenance Oil 2 Mix in the colour with which the surface area was treated.



Refreshing your wood

Maintenance & colour restoration of your wood

Renovation

1



EXTRA FOR FURNITURE

2



Ready-to-use spray for quick maintenance



Comprehensive solution for thorough maintenance

→ see next page

1



2



Maintenance in the colour of your surface

→ see next page

CARE



The oils below are maintenance products to refresh and maintain wood protected with Oil Plus 2C. The products contain 0% VOC and can be used on all oiled wooden surfaces. Both products will also increase the fluid-resistance of the treated surface, making them very suited for 'high traffic' zones which require extra protection (surfaces in public spaces, offices, restaurants, hotels etc.).



UNIVERSAL MAINTENANCE OIL

For a refreshing look

This product can be used when the surface needs a refresh, but no colour repair. It's available in the colours Pure, White and Black (choose according to the colour of the surface to be treated). In addition, the oil enhances surfaces not treated with Rubio Monocoat. It can even be used to treat varnished surfaces which are starting to form micro-cracks.

INSTRUCTIONS:

01. Take the oil and stir thoroughly until a homogeneous mixture is obtained. **02.** Apply a small amount with a brush and afterwards spread out with a beige or red Scrubby pad or a hand sander with a beige or red 5.9 inch pad (or use the Mouse Pad for smaller objects and corners). Preferably work in areas of 2 to 4 m² (areas which you can finish within ± 15 minutes, including the next step). **03.** Allow to absorb for a few minutes and then wipe away all the excess oil with a cloth or a hand sander with a white 5.9 inch pad. Each treated area should be wiped dry within 15 minutes and should not feel sticky anymore.



UNIVERSAL MAINTENANCE OIL 2 MIX

Your wood deserves the perfect mix

Universal Maintenance Oil 2 Mix can be used when the surface needs a refresh and colour repair. The Universal Maintenance Oil 2 Mix needs to be mixed with Oil Plus 2C component A in the same colour with which the surface was once treated.

INSTRUCTIONS:

01. Take the oil and add the Oil Plus 2C component A in the same colour with which the surface was treated before (ratio: 3 parts Universal Maintenance Oil to 1 part Oil Plus 2C - as provided in the packaging set). Mix thoroughly. **02.** Apply a small amount with a brush and afterwards spread out with a red Scrubby pad. Preferably work in areas of 2 to 4 m² (areas which you can finish within ± 15 minutes, including the next step). **03.** Allow to absorb for a few minutes and massage the oil into the wood with a white Scrubby pad. **04.** Wipe away all the excess oil with an Oil removal cloth. The surface should look even.

MAKE THE SURFACE DUST-FREE & CLEAN IT

with **Surface Care** or **All Natural Wood Cleaner Spray**.



UNIVERSAL MAINTENANCE OIL 2 MIX APPLICATION



WARNING SPONTANEOUS COMBUSTION

Linseed oil is a natural product and not subject to spontaneous combustion. However, oil on a cloth or other tools does entail a fire risk. The oxidation of the oil leads to heat accumulation, which can result in spontaneous combustion. Therefore, the **cloths and other tools must be soaked in water before disposal.**



- If the treated surface starts to show too much wear and tear or if the colour needs to be repaired, maintenance should be done with Oil Plus 2C. Make sure that you add Oil Plus 2C in its original colour.
- The product may not be diluted under any circumstances, unless with the indicated amount of Oil Plus 2C.

RENOVATION



DEEP CLEANER

Intense cleaner for all types of surfaces treated with Oil Plus 2C

Deep Cleaner is a curative cleaner for dirty surfaces and a preparatory cleaner for all types of surfaces treated with Oil Plus 2C (flooring, tabletops, worktops, etc.).

Deep Cleaner removes dirt and greasy soap residue left on the surface.

INSTRUCTIONS:

01. Clean the surface by using a damp sponge/mop (water only). **02.** Wipe out the diluted Deep Cleaner (max. 5% Deep cleaner to 95% water) evenly on the surface by using a sponge/mop. **03.** Scrub the treated area with a nylon scrubbing brush or Microfibre Pad in the lengthwise direction of the wood until the surface is clean. This will cause the product to foam. For stubborn stains, repeat the treatment. **04.** Remove the dissolved dirt with a damp cloth/mop and clear water until the surface looks clean. **05.** Allow it to dry well (\pm 30 minutes at a temperature of 20°C and in a well-ventilated room). **06.** In case the surface needs a reiling (when it feels rough or the colour looks faded), it should be treated with the original Oil Plus 2C colour.

Deep Cleaner is a concentrate and must therefore be diluted with water before use (max. 5% Deep Cleaner to 95% water).

OIL PLUS 2C

Protects and colours your interior wood in one single layer

If the treated surface shows too much wear and tear, or needs a colour repair, maintain with Oil Plus 2C in the original colour.

INSTRUCTIONS:

01. Stir the A-component until a homogeneous mixture is obtained. **02.** Mix the A and B-components carefully (1 to 2 minutes) with a ratio of about 3 units A to 1 unit B. **03.** Stir carefully again. **04.** Spread a small amount of Oil Plus 2C with a beige/red Scrubby pad. **05.** Let absorb for a few minutes. **06.** Remove excess oil with a cloth. The surface should not feel sticky! Let dry for 12 - 24 hours and wait at least 5 days before a first cleaning.



WARNING SPONTANEOUS COMBUSTION

Linseed oil is a natural product and not subject to spontaneous combustion. However, oil on a cloth or other tools does entail a fire risk. The oxidation of the oil leads to heat accumulation, which can result in spontaneous combustion. Therefore, the **cloths and other tools must be soaked in water before disposal.**

CLEAN THE SURFACE WITH DEEP CLEANER



OIL PLUS 2C APPLICATION

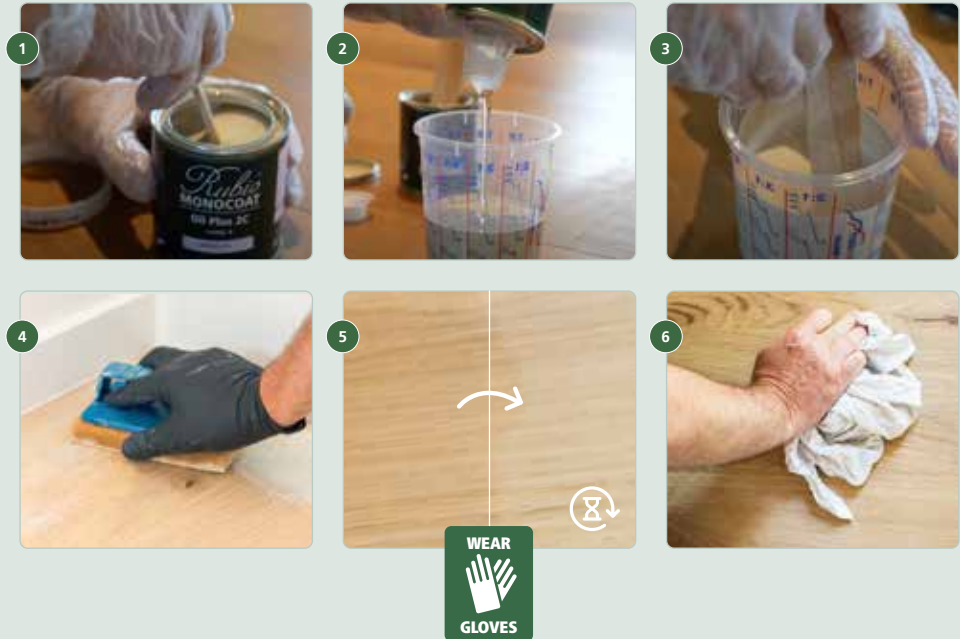

For more how to's and tips & tricks, be sure to check out our **YouTube** channel. Simply **scan the QR-code** and we'll take you there!





Design & Photography : © Dan Briker
Contractor: ZZ Contracting



© Private residence, Belgium



© East Coast Joinery Ltd, Ireland (www.eastjoinery.ie)
Photographer: Pawel Wach
Building project: Mark Byrne Engineering Ltd

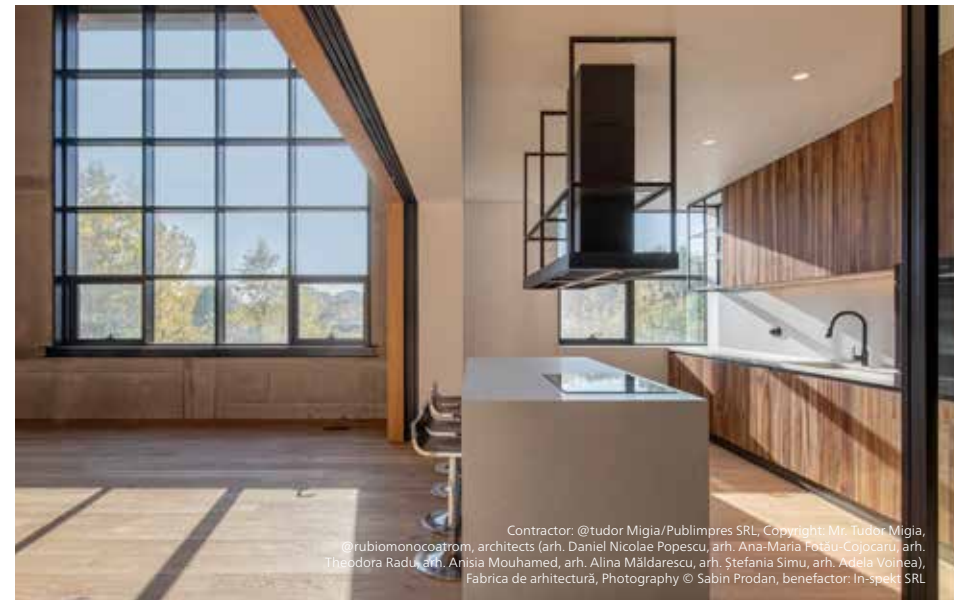

Contractor: @tudor Migia/Publimpres SRL. Copyright: Mr. Tudor Migia,
©rubiomonocotrom, architects (arh. Daniel Nicolae Popescu, arh. Ana-Maria Potău-Cojocaru, arh. Theodora Radu, arh. Anisia Mouhamed, arh. Alina Măldărescu, arh. Ștefania Simu, arh. Adela Voinea),
Fabrica de arhitectură, Photography © Sabin Prodan, benefactor: In-spekt SRL

Indicate the colour you used:

Date of application:

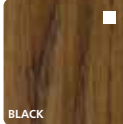
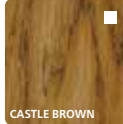
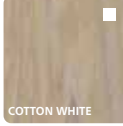
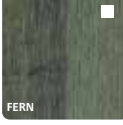
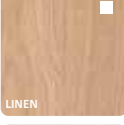
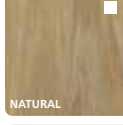
 AFFOGATO	 ALMOND	 ARABICA	 ASH GREY	 BLACK	 BOURBON	 CASTLE BROWN
 CHARCOAL	 CHOCOLATE	 COCOA	 CORTADO	 COTTON WHITE	 DARK OAK	 DARK ROAST
 DULCE	 DUNES	 FERN	 GOLDEN HOUR	 HAZELNUT	 HONEY	 LIGHT ROAST
 LINEN	 MACCHIATO	 MIDNIGHT SKY	 MIST	 MIST 5%	 MOCHA	 NATURAL
 OYSTER	 PURE	 RED VELVET	 SHELL GREY	 SMOKE	 SMOKE 5%	 SUPER WHITE
 VANILLA	 VIENNA	 WALNUT	 WHITE	 WHITE 5%	 CUSTOM-MADE	

Name of your custom-made colour:

PreColour: NO YES - Colour:

Pre-Aging: NO YES - Colour:

YOUR SURFACE INSTALLER / DISTRIBUTOR:

